

VILLAGE :- KISHANBAGH

KHASRA NO.	AREA CALCULATION (HEC.)
1	4.46
27	12.47
28	3.49
29	2.08
30	6.04
49/2	0.33
33/2	0.41
33/1	0.46
32	0.84
34	0.25
46	1.18
45	0.32
44/1	1.05
35	0.56
43	0.56

VILLAGE :- KISHANBAGH

KHASRA NO.	AREA CALCULATION (HEC.)
36	0.38
37	0.23
38	0.50
39	0.55
40	0.049
42	0.020
44	0.035
48	0.15
49/450	0.018
50	2.39
104	0.44
106	0.93
51	0.44
103	0.16

VILLAGE :- BASSI SITARAMPURA

KHASRA NO.	AREA CALCULATION (HEC.)
22	24.14
124	1.36
43	0.66
166	2.57
167	2.24
65	1.46
168	0.09

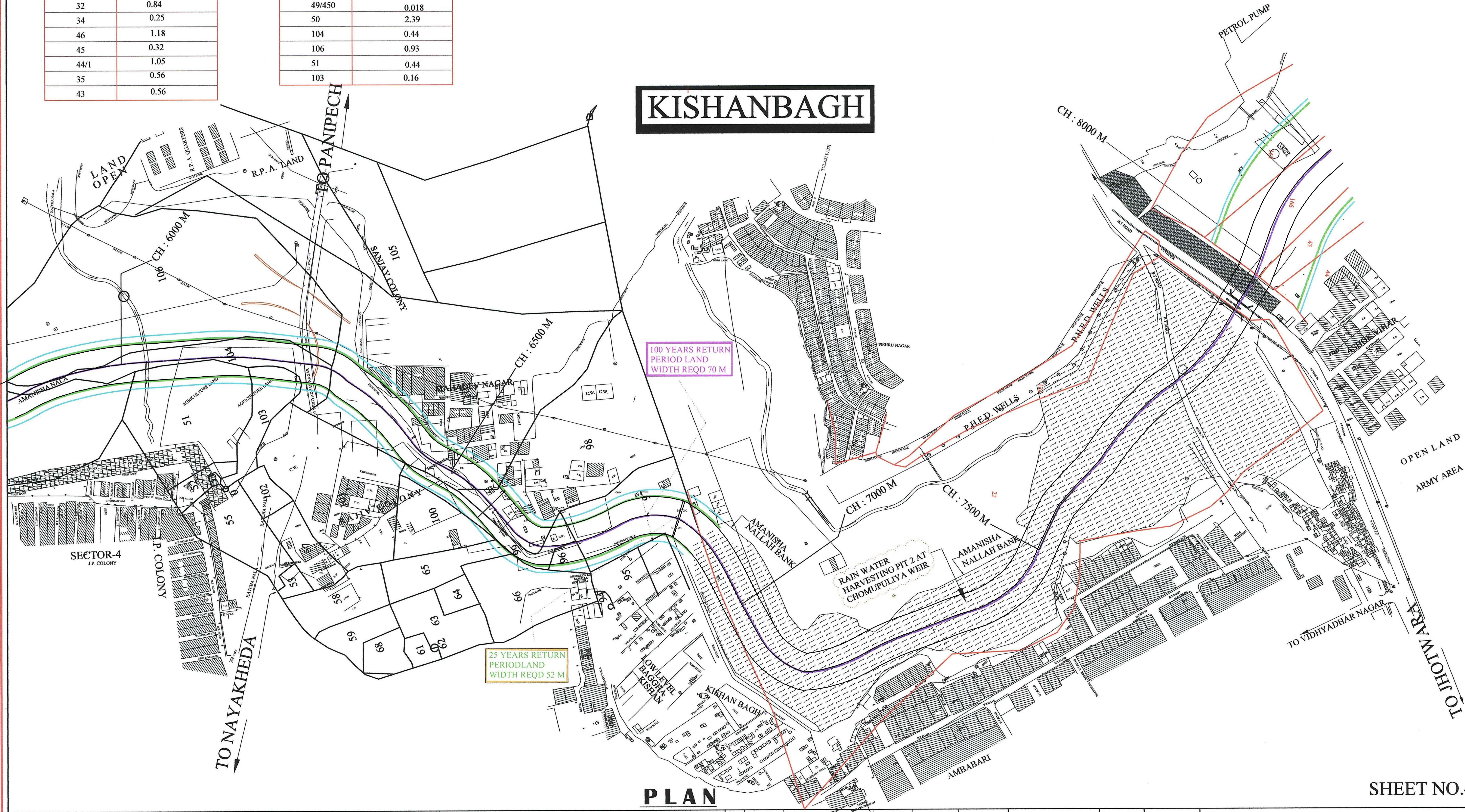

PLAN

SHEET NO.4

NOTE :
All dimensions are in metres
unless otherwise indicate.

- LEGEND : PLAN
- 1. Proposed Centre Line
 - 2. Top Width For 25 Years Flood Frequency
 - 3. Land Width Req'd. For 100 Years Flood Frequency

NO.	DATE	DESCRIPTION	DRAWN	CHECKED	APPROVED
REVISIONS					

THIS DRAWING IS THE
SOLE PROPERTY OF
JAIPUR DEVELOPMENT AUTHORITY
IT IS SUBJECT TO THEIR
RECALL AND MUST NOT
BE LENT OR COPIED OR
REPRODUCED WITHOUT
THEIR WRITTEN PERMISSION
NOR USED FOR ANY
PURPOSED OTHER THAN
FOR WHICH IT IS ISSUED.

DESIGNED	SUJ.K
DRAWN	DEEPIKA
CHECKED	SUJ.K
APPROVED	S.K.BHARDWAJ
DATE	JAN.2009

CLIENT: JAIPUR DEVELOPMENT AUTHORITY	
JOB NO. C - 702	JOB : CONSULTANCY FOR DESIGN OF STORM WATER DRAIN
TITLE : PROPOSED PLAN OF AMANISHA KA NALLAH WITH KHASRA NO.S	
SCALE : 1CM : 40M.	DRG. NO. SCPL/702/01
REV.	
SNC - LAVALIN	
Span Consultants Pvt. Ltd. (A Member of SNC - LAVALIN Group)	
Mindmill Corporate Tower 4th & 5th Floor, Plot 24a, Sector - 16a, Film City Noida, Up 201301	